



MC-5L216



Super & Even Cooling

70Mins Rapid Cooling(32°C→6°C)&±1°C Uniformity.



Flexvolt(100V~240V)

Stable operation at 100-240-V, 50/60Hz.



Energy-Saving & Low Noise

1.5kWh/24h Power Consumption & 35dB Low Noise.

■ Top Cooling

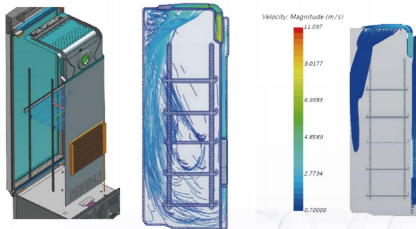

■ Built-in Air Duct

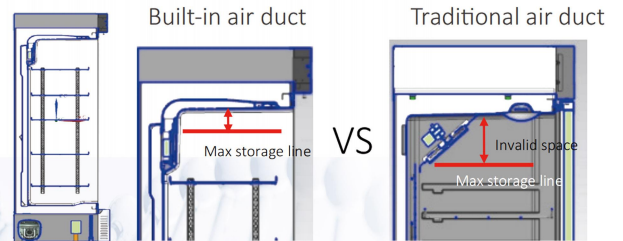

■ Dual Display



■ DC Turbo Fan

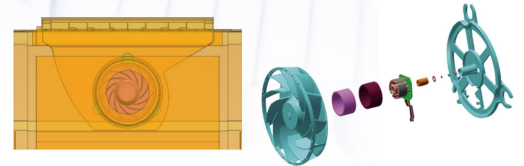

R600a Refrigerant

Environmentally friendly refrigerant

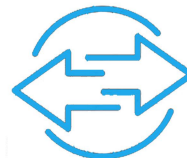

Universal Interface

- ① Dual test ports (Ø25mm)
- ② USB datalogger output
- ③ NO/NC alarm relays
- ④ RS485 Optional



HEMF-LiB

Last 50hrs when power off.



6 Sensors

Support multiple alarms

| Application, Rating, & Electrical Data | |
|--|---|
| Application | Pharmacy refrigerator |
| Storage Volume (L/Cu.Ft) | 216/7.63 |
| Temperature Range | 2°C to 8°C/35.6°F to 46.4°F |
| Default Set Point | +5°C |
| Power Supply | 100-240 ~ V/50Hz/60Hz |
| Current | 3A (100V) 1.5A(240V) |
| Power Cord Length | 1.7m |
| Certification | CE |
| Door type | Electrically Heated Glass Door |
| Application Environment | Non-corrosive, non-flammable, non-explosive |
| Ambient Operating Temperature | +16°C to +32°C |
| Refrigeration | |
| Refrigeration System | Forced-air/hydrocarbon Refrigerant |
| Compressor | Hermetic |
| Condenser Type | Air-cooled |
| Expansion Device | Cap tube |
| Evaporator Type | Fin and tube |
| Defrost Method | Automatic |
| Refrigerant | R600a |
| Controller / Configuration Settings | |
| Display screen | LED |
| Controller Type | Microprocessor |
| Security | Lockable door, password protected settings |
| Control Sensor | NTC, stainless steel |
| Communication Ports | USB, Remote alarm contacts |
| Power Failure Alarm | Yes |
| High/Low Alarms | Yes, fully adjustable |
| Door Ajar Alarm | Yes, fully adjustable |
| Min/Max Temperature | Yes, display and reset |
| Download | Yes, via USB. PDF |
| Temperature Log | Yes, download via USB |
| Temperature Monitoring Ballast | Yes |
| Battery Back-up | Yes, 50 hr display and alarm back-up Rechargeable 12V, Li-ion |
| Dimensions and Construction | |
| Interior (w*d*h)mm | 497*440*1150 mm |
| Exterior (w*d*h)mm | 595*597*1452 mm |
| Access Port | Access Port- for external monitoring probe(s) (25 mm diameter) |
| Shelves | 4 24 kg max capacity/drawer |
| Wheels | 4, two swivel casters + two leveling feet |
| Net Weight | 61 kg |
| Gross Weight | 67 kg |

| Performance Characteristics (normal operating conditions) | |
|---|-----|
| Uniformity (°C) | ±1 |
| Recovery to 8°C after 1 min door opening (min) | 9 |
| Temperature fluctuation (°C) | 3 |
| Energy consumption (kWh/day) | 1.5 |
| Noise emission (dB) | 35 |
| Heat rejection (BTU/hr) | 320 |
| Pull-down time to 6°C (min) | 70 |

All performance data from 216L refrigerator, 25°C ambient, 5.0°C

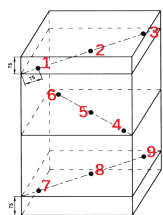
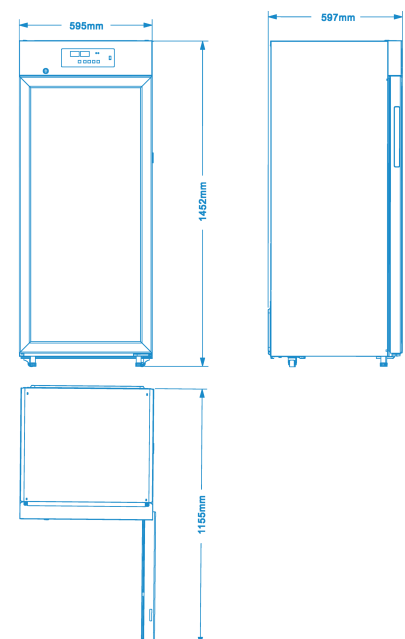
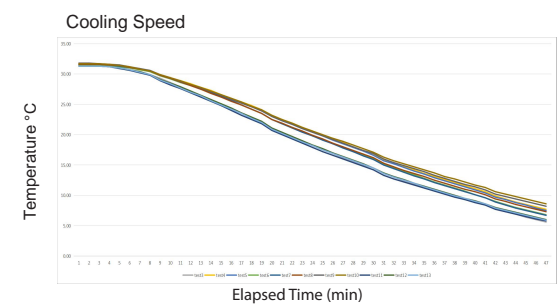
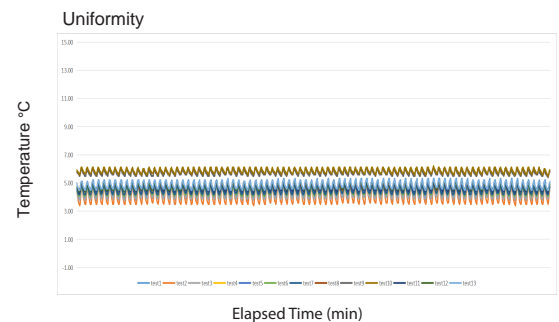

Location of test probes

Typical Temperature Map

| | test1 | test2 | test3 | test4 | test5 | test6 | test7 | test8 | test9 |
|-----|-------|-------|-------|-------|-------|-------|-------|-------|-------|
| Avg | 4.52 | 4.09 | 4.26 | 4.62 | 4.69 | 4.43 | 4.49 | 4.76 | 5.72 |
| Max | 5.30 | 5.80 | 4.80 | 5.10 | 5.10 | 4.90 | 4.90 | 5.10 | 6.00 |
| Min | 3.80 | 3.40 | 3.80 | 4.20 | 4.30 | 4.10 | 4.20 | 4.50 | 5.40 |

